

PLANNING APPROVED 16/04673/FU

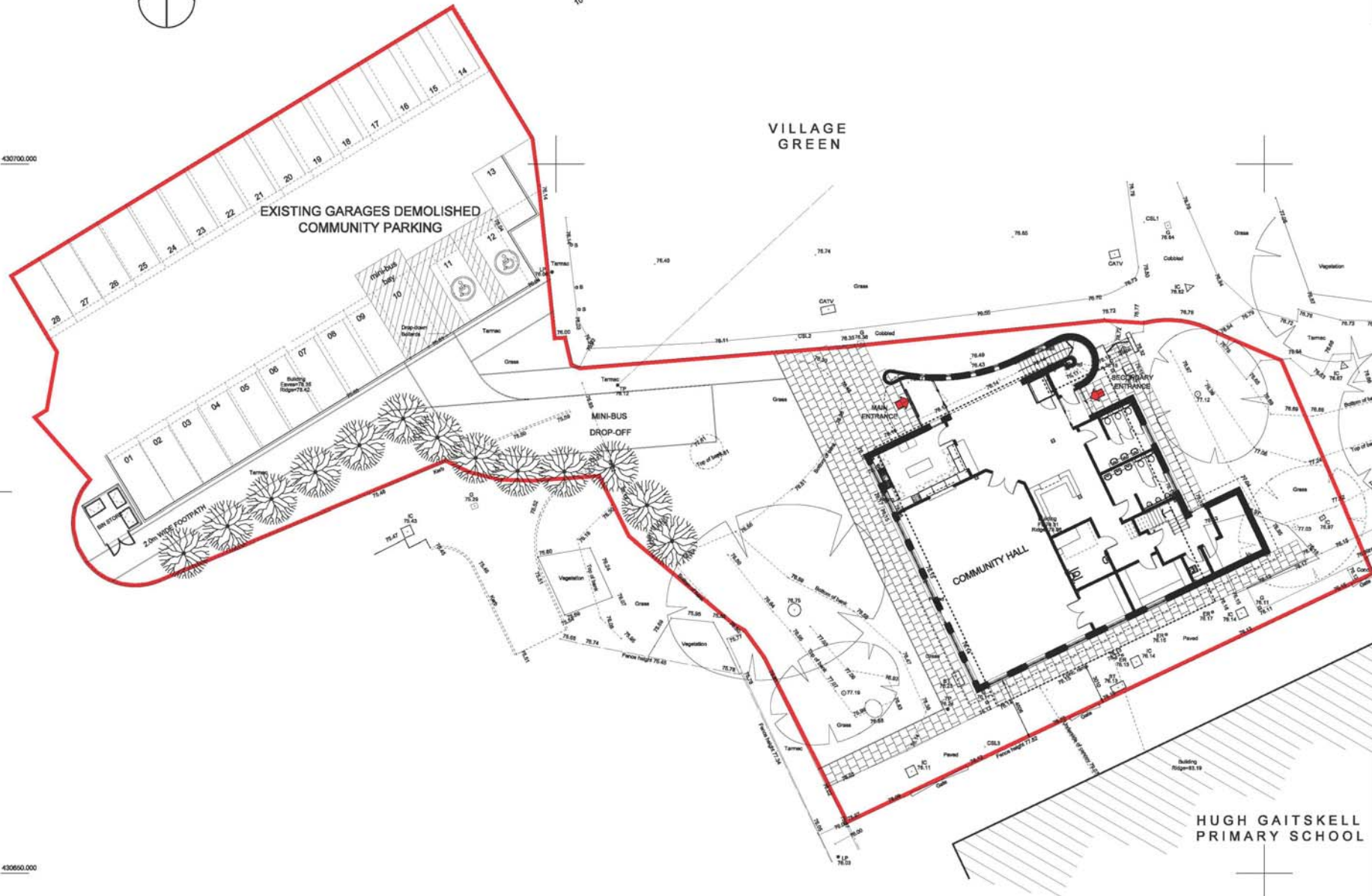

NOTES
 1. CONTRACTORS AND SUB-CONTRACTORS MUST CHECK AND AGREE ALL DIMENSIONS BEFORE PROCEEDING OTHERWISE BE CONSIDERED AS WORKING AT THEIR OWN RISK.
 2. CONTRACTORS ARE TO BE RESPONSIBLE FOR OBTAINING THE ADVICE OF ALL AGENCIES AND OBTAINING THE NECESSARY CONSENTS AND ANY OTHER RELATED DOCUMENTS BEFORE THE STARTING OF WORK.
 3. WRITTEN DIMENSIONS ONLY ARE TO BE USED FROM THIS DRAWING - IF ANY AND DIMENSIONS EXIST FOR CLARIFICATION.

ACCOMMODATION	
GROUND FLOOR	353m ²
FIRST FLOOR	232m ²
TOTAL	585m ²

28nr CAR PARKING (1 space per 21m²)

- MATERIALS**
- EXTERNAL WALLS BRICK & RENDER
 - VERTICAL TIMBER CLADDING
 - ROOF CONCRETE INTERLOCKING SLATE
 - TILE, COLOUR GREY
 - RAINWATER GOODS UPVC GUTTERS
 - AND DOWNPIPES, COLOUR BLACK
 - UPVC FASCIAE AND SOFFITS,
 - COLOUR: WHITE
 - WINDOWS DOUBLE GLAZED
 - ALUMINIUM WINDOWS PC
 - CAR PARKING TARMAC
 - FOOTPATH 600 x 600 x 50mm CONC SLABS

108.86	PROPOSED LEVELS
167.80	EXISTING LEVELS

- TREES TO BE RETAINED
- TREES TO BE REMOVED
- NEW TREES



1:200 SCALE IN METRES

DATE	LET	REVISION	DRW	CHK
------	-----	----------	-----	-----

W&P
Waller & Partners
 ARCHITECTS
 INTERIOR DESIGNERS

PROJECT MANAGERS
 CON COORDINATORS

OFFICE: 2 FLOORS, 10000 SQ FT
 10000 SQ FT
 10000 SQ FT
 10000 SQ FT
 10000 SQ FT

CONTRACT
VILLAGE COMMUNITY CENTRE
BEESTON
SOUTH LEEDS
HEALTH FOR ALL (LEEDS) LTD

DRAWING
PROPOSED
SITE PLAN

SCALE	1:200	FORM	AC	DATE	28.04.17
NO.	A1	NO.	A2	NO.	
DRAWING NO.	4654/020		REVISION		

THIS DRAWING AND THE COPYRIGHTS AND PATENTS THEREIN ARE THE ARCHITECTS PROPERTY AND ARE TO BE USED AS INDICATED ONLY UNDER CONTRACT